

Installation Guidelines and Recommendations

Tools Needed

Tape Measure, Chalk Line, Razor Blade Knife, Straight Edge.

Prior to Installation

Install carpet tiles directly over concrete, plywood, OSB, particleboard, vinyl, ceramic, porcelain, laminate, and hardwood finished floors. Do not install over existing carpet, carpet padding, or any floating type flooring. The floor should be secure, smooth, flat, clean, dry and free of any debris that could affect adhesion such as dirt, oil, grease, paint, wax, or dust. Remove anything that is not well adhered to the floor. It is recommended to remove or seal old adhesives, finishes, or waxes. Damp mopping and vacuuming is recommended to ensure that floor is clean. Fill all cracks and depressions with appropriate floor filler or leveling compound. Floor temperature should be between 65 and 95 degrees Fahrenheit. Store carpet tiles at room temperature for 24 hours prior to installation.

Installation

Measure the area to determine the best layout. It is preferable to have larger cuts at perimeter walls. Often walls are not straight and the cut size may change from one end of the room to the other. Take into account doorways or other partitions when determining the best starting point.

After determining your starting point snap chalk lines to use as a guide. Layout chalk lines that bisect at the starting point and are at right angles.

Installation should begin in the center of the room. Lay tiles in a straight grid or use a horizontal ashlar (brick) pattern.

Remove the liner from the back of the tile and align the tile with the two chalk lines. Using the arrows on the back of the tiles, take care that all tiles are laid in the same direction. As you lay each tile brush back the face fiber to keep it from being trapped between the tiles. Fit the tiles snugly together but do not compress the tiles.

Around the perimeter, measure the size needed and mark tiles on the back with a felt tip or ball point pen. Prior to cutting check the arrow to be certain that the fill tile will run the same direction as the other tile in the room. Cut tiles from the back and position the cut edge at the wall.

When the installation is complete, vacuum the carpet to remove small fragments of carpeting and debris.

**Make Sure Floor is Clean
and Ready for Carpet**

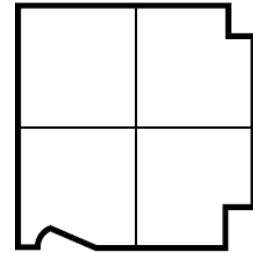

Chalk Line Layout

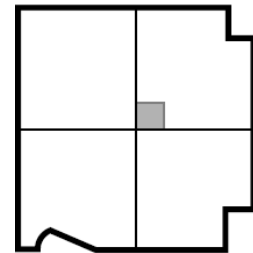

Starting Point Tile

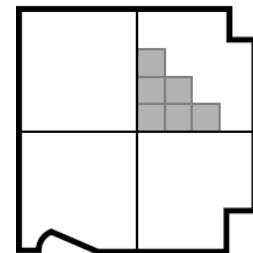

Standard Installation

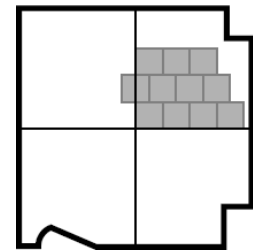

**Optional Horizontal Ashlar
(Brick) Installation**